

5 Alder Grove, Stretford, Trafford, M32 8PG



JP&Brimelow
ESTATE AGENTS

Offers In The Region Of £400,000

 3  1  1  B

VIDEO TOUR AVAILABLE A beautifully presented THREE BEDROOM linked-detached property, situated on a quiet and leafy cul-de-sac within easy reach of the centre of Chorlton. The property is positioned on one of Stretford's most popular residential roads and is within walking distance of all local amenities off Chester Road, the Metrolink station on Edge Lane, Longford Park, and Beech Road, with good local Primary/Secondary Schools nearby. The well-planned and spacious property comprises an entrance hallway with a useful storage cupboard, a through lounge/dining room with French doors opening onto the rear garden, and a fully fitted kitchen with access to the garage/utility room. To the first floor, a landing provides access to three bedrooms and a three-piece bathroom suite. The property further benefits from gas fired central heating, an alarm system, a driveway providing off-road parking, and gardens to both the front and rear. Internal inspection is highly recommended to appreciate this home.





EPC Chart

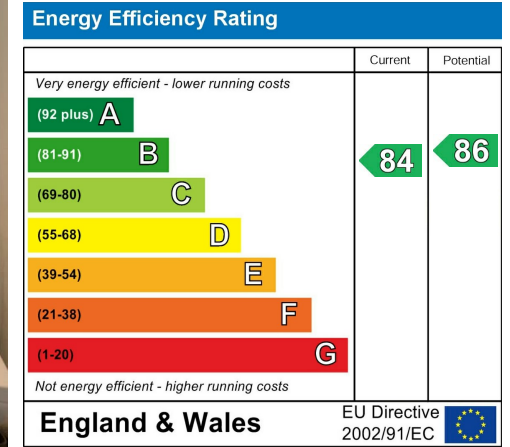

Tenure: **Freehold** Council Tax Band: **C**

Ground Floor



First Floor

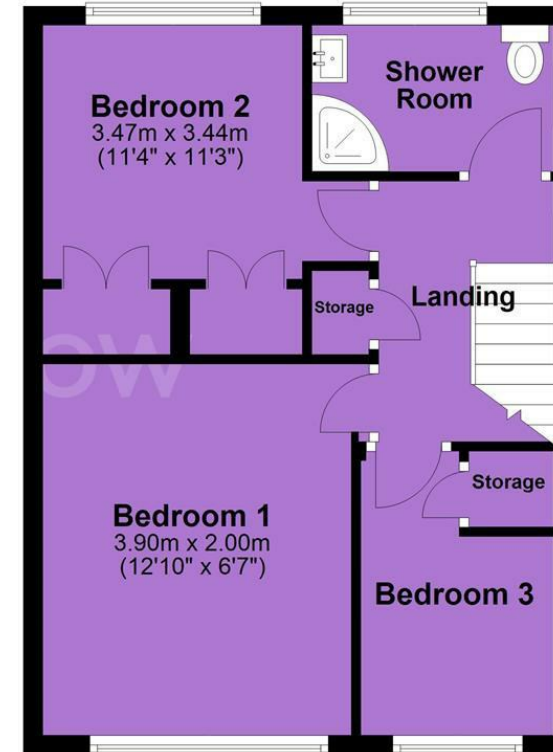

JP & Brimelow Estate Agents Ltd
430 Barlow Moor Road, Manchester, M21 8AD
Tel: 0161 8822233
E: sales@jpbrimelow.co.uk www.jpandbrimelow.co.uk



JP & Brimelow
ESTATE AGENTS

NOTICE: JP & Brimelow Estate Agents Ltd for themselves and for the vendors or lessors of this property whose agents they are give notice that:
(i) the particulars are set out as a general outline only for the guidance of intending purchasers or lessees, and do not constitute, nor constitute part of, an offer or contract;
(ii) all descriptions, dimensions, references to the condition and necessary permissions for use and occupation, and other details are given in good faith and are believed to be correct but any intending purchasers or tenants should not rely on them as statements or representations of fact but must satisfy themselves by inspection or otherwise as to the correctness of each of them;
(iii) no person in the employment of JP & Brimelow Estate Agents Ltd has any authority to make or give any representation or warranty whatever in relation to this property.

jpbndbrimelowstateagents

@jpbndbrimelow